



# F-SERIES RIGID FIBERGLASS FITTINGS

FOR DOUBLEWALL FIBERGLASS SUMPS

F-1X-SS-D / F-1X-RR-D / F-XX-LS-D / F-XX-TS-D

DOUBLEWALL FITTINGS FOR CONDUIT AND FIBERGLASS PIPE

F-SERIES DOUBLEWALL FAMILY

## Conduit Series Pass-through Fitting

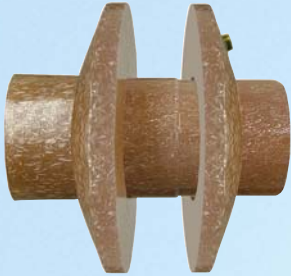

### PRODUCT SPECS:

Material . . . . UL Fiberglass

PART #	O.D.	Length	Weight	Engineered for:
F-17-SS-D*	5"	5.25"	3 lbs	3/4" Hot-dip Galvanized Conduit
F-10-SS-D*	5"	5.25"	3 lbs	1" Hot-dip Galvanized Conduit
F-17-RR-D	5"	5.25"	3 lbs	3/4" RobRoy PVC-Coated Conduit
F-10-RR-D	5"	5.25"	3 lbs	1" RobRoy PVC-Coated Conduit

**\* IF BRINE (SALINE) IS USED - YOU MUST USE "RR" MODELS**

## Size over Size Termination Fitting



### PRODUCT SPECS:

Material . . . . UL Fiberglass

PART #	O.D.	Length	Weight	Engineered For:
F-32-TS-D:	7"	5.25"	5 lbs	3" over 2" Fiberglass Pipe
F-32-TS-D-ADJ:	7"	5.25"	5 lbs	3" over 2" Fiberglass Pipe
F-43-TS-D:	7.5"	5.25"	6 lbs	4" over 3" Fiberglass Pipe
F-43-TS-D-ADJ:	7.5"	5.25"	6 lbs	4" over 3" Fiberglass Pipe
F-64-TS-D*:	11"	5.25"	11 lbs	6" over 4" Fiberglass Pipe

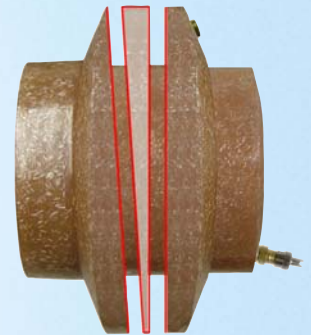

F-32-TS-D-ADJ  
Angle-Adjustable  
0° - 5°

## Ameron LCX Termination Fitting



### PRODUCT SPECS:

Material . . . . UL Fiberglass

PART #	O.D.	Length	Weight	Engineered For:
F-22-LS-D:	7"	5.25"	5 lbs	2" Ameron LCX Fiberglass Pipe
F-33-LS-D:	7.5"	5.25"	6 lbs	3" Ameron LCX Fiberglass Pipe

Reduce Labor & Material

Minimize Installation Errors

All "FRP" Construction

3rd Party Approved

Stock ONE fitting for both SMITH / AMERON



**S. Bravo Systems, Inc. - The Leader in Secondary Containment**

2929 Vail Ave. | Commerce, CA | 323-888-4133 | FAX: 323-888-4123 | www.sbravo.com



# F-SERIES

## PASS -THROUGH PIPING

The F-Series penetration fittings allow the primary pipe to pass through. The secondary pipe terminates within the fitting, eliminating the need for clamshells or reducers at the fitting face.

\* ALL SMITH FIBERCAST™ PIPE, BRAVO 9000-B SUMPS, FLEX CONNECTORS AND SHEAR VALVES ARE FOR ILLUSTRATION PURPOSES ONLY.

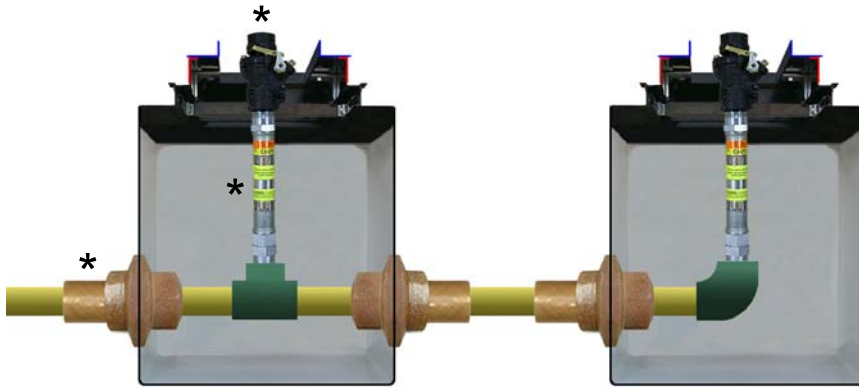

**Optional:** SS Test Port to test / monitor Secondary Pipe

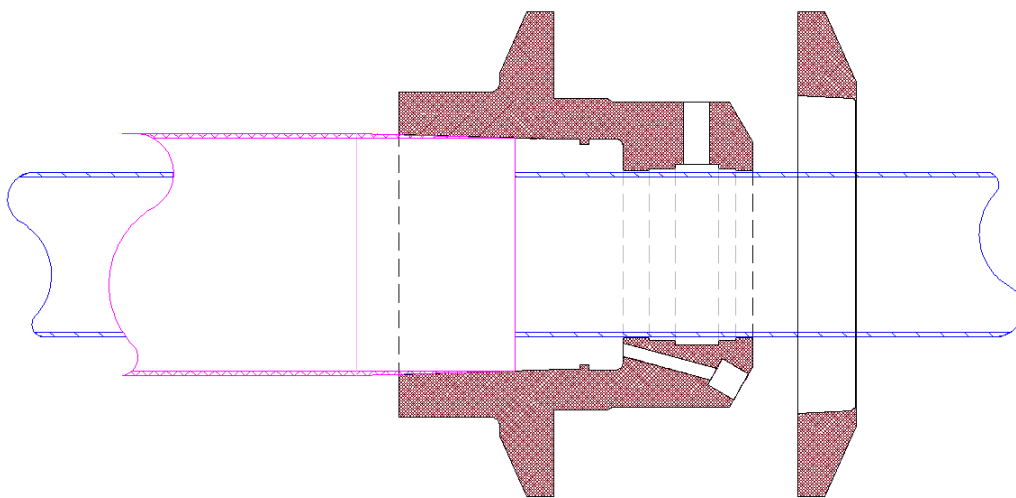

Primary passes through fitting for testing, while not permanently installed yet.

After primary passes testing, the primary is then sealed to the fitting by adhesive injection

The secondary is then sealed and tested.

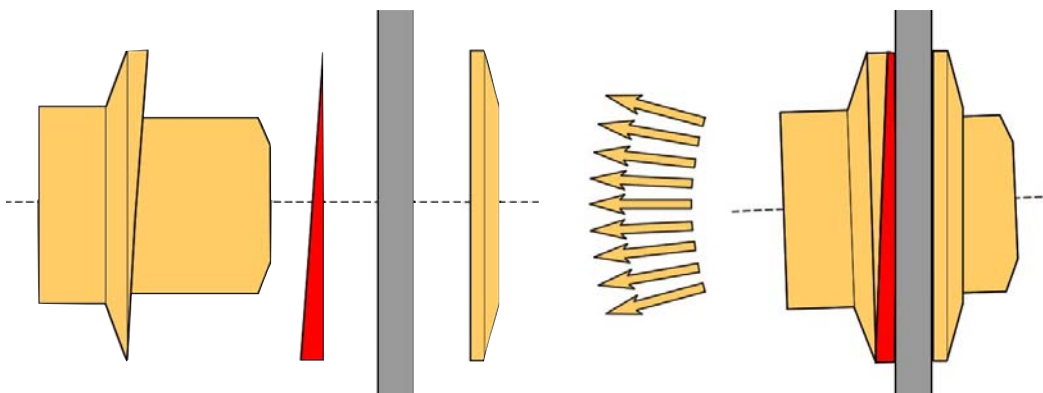

The Adjustable Variant of the F-Series Fitting utilizes an additional loose flange machined with a 2.5° angle to match a 2.5° angle on the integrated flange of the body. Rotating these together allows a 0° - 5° angle adjustment.

**S. Bravo Systems, Inc. - The Leader in Secondary Containment**

2929 Vail Ave. | Commerce, CA | 323-888-4133 | FAX: 323-888-4123 | [www.sbravo.com](http://www.sbravo.com)

