

**PATENTS
PENDING**

FF-SERIES Fiberglass Entry Fittings

ALL-FRP 'FLANGE' FITTING FOR SINGLEWALL SUMPS
FOR SMITH / AMERON FRP PIPE AND STEEL CONDUIT
MANUFACTURED OF FIBERGLASS

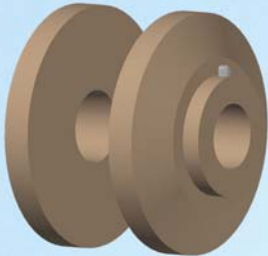

Flange Fittings for Conduit (FLAT WALLS)

PART #	O.D.	Length	Angle	Engineered for:
F-07-FF:	5"	1-1/4"	5°	3/4" Hot-dip Galvanized
F-10-FF:	5"	1-1/4"	5°	1" Hot-dip Galvanized
F-07-FFRR:	5"	1-3/8"	5°	3/4" RobRoy PVC-Coated
F-10-FFRR:	5"	1-3/8"	5°	1" RobRoy PVC-Coated

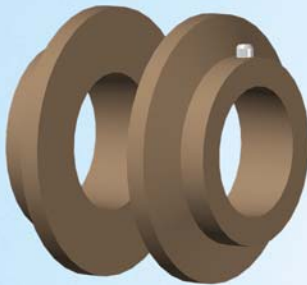

Flange Fittings for Flat Walls

PART #	O.D.	Length	Angle	Engineered for:
F-20-FF:	5"	1-1/4"	5°	2" Size over Size FRP Pipe
F-30-FF:	7"	1-5/16"	5°	3" Size over Size FRP Pipe
F-40-FF:	7.5"	1-5/16"	5°	4" Size over Size FRP Pipe
F-20-FF-LCX:	5"	1-1/4"	5°	2" Ameron LCX FRP Pipe
F-30-FF-LCX:	7"	1-5/16"	5°	3" Ameron LCX FRP Pipe
F-40-FF-LCX:	9"	1-3/8"	5°	4" Ameron LCX FRP Pipe

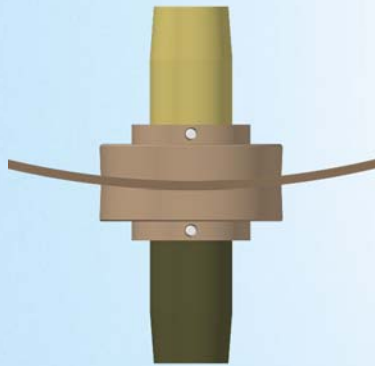

Flange Fittings for Round Walls

PART #	O.D.	Length	Angle	Engineered for:
F-07-FF-RND:	5"	1-5/16"	5°	3/4" Hot-dip Galvanized
F-10-FF-RND:	5"	1-5/16"	5°	1" Hot-dip Galvanized
F-07-FFRR-RND:	5"	1-5/16"	5°	3/4" RobRoy PVC-Coated
F-10-FFRR-RND:	5"	1-5/16"	5°	1" RobRoy PVC-Coated
F-20-FF-RND:	5"	1-5/16"	5°	2" Size over Size FRP Pipe
F-30-FF-RND:	7"	1-5/16"	5°	3" Size over Size FRP Pipe
F-40-FF-RND:	8"	1-7/8"	5°	4" Size over Size FRP Pipe
F-20-FF-LCX-RND:	5"	1-5/16"	5°	2" Ameron LCX FRP Pipe
F-30-FF-LCX-RND:	7"	1-5/16"	5°	3" Ameron LCX FRP Pipe
F-40-FF-LCX-RND:	8"	1-7/8"	5°	4" Ameron LCX FRP Pipe

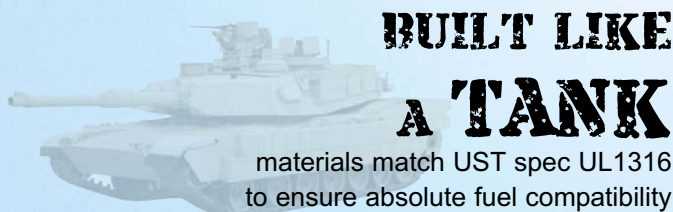

NO

- Plastic
- Rubber
- Clamps
- Sealant
- Nuts
- Bolts

13A